

UCW SERIES FRONT COUNTERS

UNDER COUNTER WINDOW COOLER DISPLAY



ALL METAL CONSTRUCTION



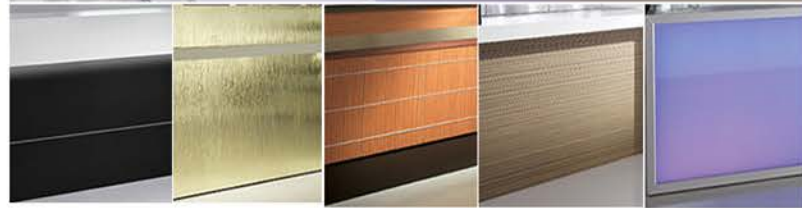

STANDARD FEATURES

- ETL approval for UL safety and NSF sanitation
- Patented access system for electrical plumbing and refrigeration
- Stainless steel adjustable feet
- Aisi 304 stainless steel module with BA external finish and 2B internal stainless steel
- Round corners inside the model
- Ecological CFC free polyurethane foam
- Stainless steel intermediate and adjustable shelf
- High capacity evaporator with fan system
- Digital Dixell control with safe housing
- Stainless steel counter bar
- Stainless steel doors
- Ventilated refrigerated
- Self contained
- Steel frame



OPTIONS

- Glass doors
- Stone top
- Casters
- Work top options:

-  Flat
-  Back splash 8"H (199mm)
-  Pre-arrangement for service top
-  Round per "Compact Round"

UNDER COUNTER WINDOW DISPLAY SPECIFICATIONS

CODES	MODELS	LENGTHS	DEPTHS	HEIGHT	WEIGHTS	VOLTAGES	AMPS
BRPVF2P65H75G	1300A	51 1/4" (1300mm)	26 1/4" (665mm)	44 1/2" (1130mm)	345	120	6
BRPVF2P65H75G	1300B	51 1/4" (1300mm)	30" (760mm)	44 1/2" (1130mm)	345	120	6
BRPVF2P58H75G	1800A	70 3/4" (1800mm)	26 1/4" (665mm)	44 1/2" (1130mm)	440	120	8
BRPVF2P65H75G	1800B	70 3/4" (1800mm)	30" (760mm)	44 1/2" (1130mm)	440	120	8

A= 25 3/4" (655mm) | B= 29 1/2" (750mm)



361-367 Beach Road, Burlingame, CA 94010
 Tel: 855.885.2400 | 650.342.2400 | Fax: 650.342.7400
 sales@oscartek.com | www.oscartek.com



UCW SERIES FRONT COUNTERS

UNDER COUNTER WINDOW COOLER DISPLAY

OPTIONAL BACK SPLASH 7 3/4" H (200mm) SHOWN

**A - 24 1/2" D (625mm)
SIDE VIEW**

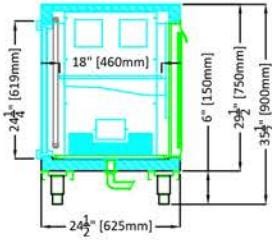

1300

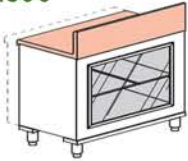

**B - 28 1/4" D (720mm)
SIDE VIEW**

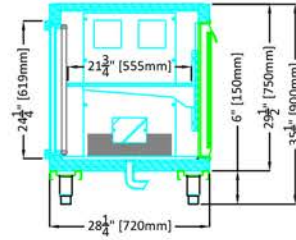

1800

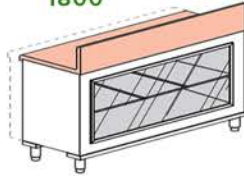

**A - 24 1/2" D (625mm)
SIDE VIEW**

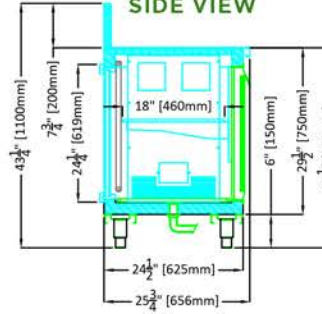

**B - 28 1/4" D (720mm)
SIDE VIEW**

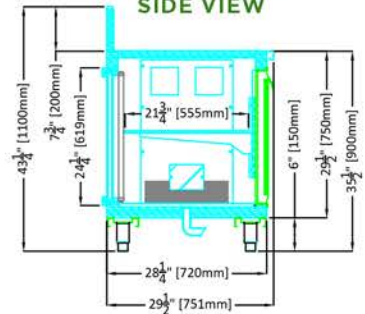

PLAN VIEWS

A - 24 1/2" D (625mm)

1300 - 50 3/4" L

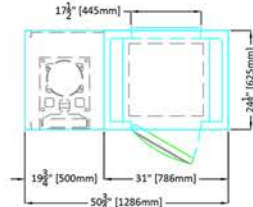

1800 - 70 3/4" L

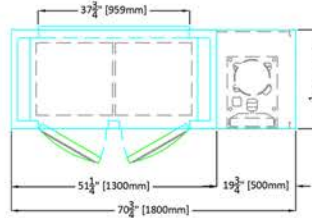

2300 - 90 1/2" L

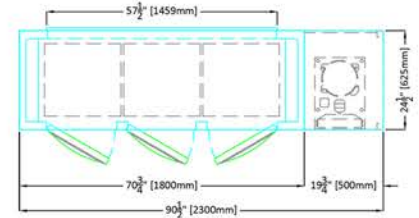

B - 28 1/4" D (720mm)

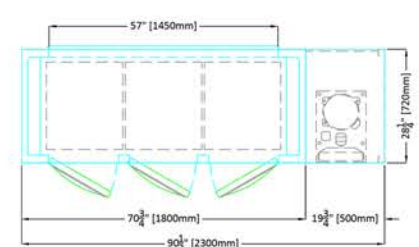
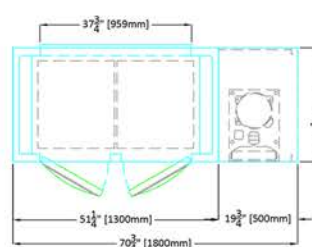
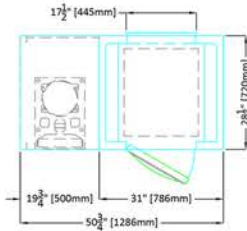

REAR ELEVATIONS (OPERATOR SIDE)

1300 - 50 3/4" L

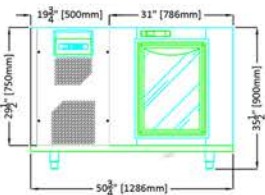

1800 - 70 3/4" L

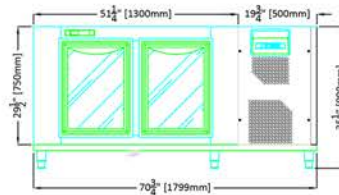

2300 - 90 1/2" L

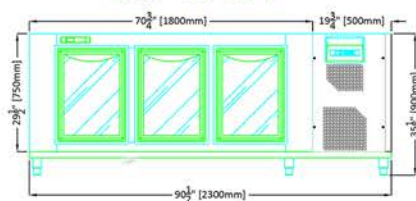

FRONT ELEVATIONS (CUSTOMER SIDE)

1300 - 50 3/4" L

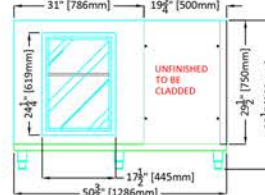

1800 - 70 3/4" L

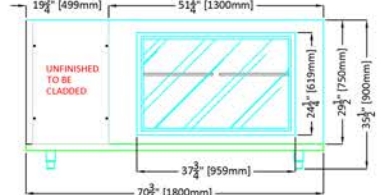

2300 - 90 1/2" L

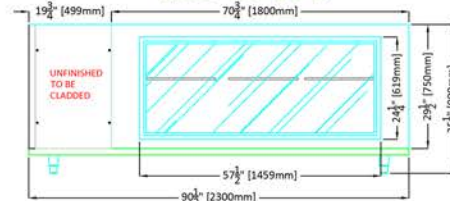

361-367 Beach Road, Burlingame, CA 94010
Tel: 855.885.2400 | 650.342.2400 | Fax: 650.342.7400
sales@oscartek.com | www.oscartek.com

