

## ALL METAL CONSTRUCTION

### SWING DOORS



### SLIDING DOORS







### STANDARD FEATURES

- Stainless steel adjustable feet
- Aisi 304 stainless steel finish
- Stainless steel intermediate adjustable shelf
- Stainless steel Aisi 304 working top
- Steel frame

### OPTIONS

- Stainless steel swing doors
- Stainless steel sliding doors
- Stone top (refer to Oscartek finishes)
- LED interior light
- Casters
- Work top options:

-  Flat
-  Back splash 8"H (199mm)
-  Pre-arrangement for service top
-  Round per "Compact Round"

NEUTRAL COUNTERS SPECIFICATIONS					
MODELS	LENGTHS	DEPTHS	HEIGHT	# OF DOORS	WEIGHTS (LBS)
500A	20" (500mm)	22 3/4" (580mm)	44 1/2" (1130mm)	N/A	70
500B	20" (500mm)	25 3/4" (655mm)	44 1/2" (1130mm)	N/A	74
1000A	40" (1000mm)	22 3/4" (580mm)	44 1/2" (1130mm)	2	123
1000B	40" (1000mm)	25 3/4" (655mm)	44 1/2" (1130mm)	2	128
1250A	50" (1250mm)	22 3/4" (580mm)	44 1/2" (1130mm)	2	143
1250B	50" (1250mm)	25 3/4" (655mm)	44 1/2" (1130mm)	2	150
1500A	60" (1500mm)	22 3/4" (580mm)	44 1/2" (1130mm)	2	150
1500B	60" (1500mm)	25 3/4" (655mm)	44 1/2" (1130mm)	2	155
2000A	80" (2000mm)	22 3/4" (580mm)	44 1/2" (1130mm)	2	187
2000B	80" (2000mm)	25 3/4" (655mm)	44 1/2" (1130mm)	2	195
2500A	98" (2500mm)	22 3/4" (580mm)	44 1/2" (1130mm)	2	225
2500B	98" (2500mm)	25 3/4" (655mm)	44 1/2" (1130mm)	2	238
3000A	118" (3000mm)	22 3/4" (580mm)	44 1/2" (1130mm)	2	275
3000B	118" (3000mm)	25 3/4" (655mm)	44 1/2" (1130mm)	2	286

A= 22 3/4"D (580mm) | B= 25 3/4"D (655mm)

# NC SERIES FRONT & BACK COUNTERS

# NEUTRAL COUNTERS

OPTIONAL BACK SPLASH 8" H (199mm) SHOWN

**A - 22 3/4" D (580mm)  
SIDE VIEW**

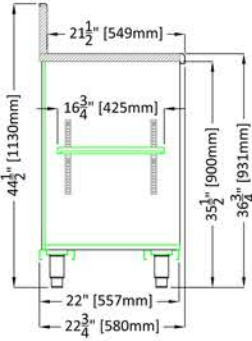

**B - 25 3/4" D (655mm)  
SIDE VIEW**

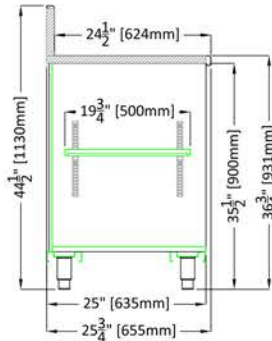

**500**



**1000**



**1250**



**1500**



**2000**



**2500**



**3000**

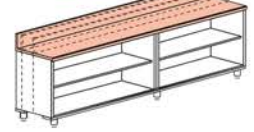

## PLAN VIEWS

**A - 22 3/4" D (580mm)**

**500**



**1000**

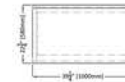

**1250**

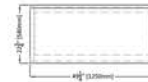

**1500**



**B - 25 3/4" D (655mm)**

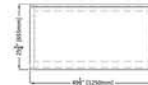

**A - 22 3/4" D (580mm)**

**2000**



**2500**



**3000**



**B - 25 3/4" D (655mm)**

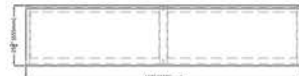

## REAR ELEVATIONS (OPERATOR SIDE)

**500**

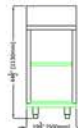

**1000**

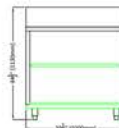

**1250**

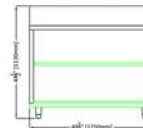

**1500**



**2000**

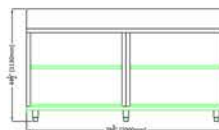

**2500**



**3000**

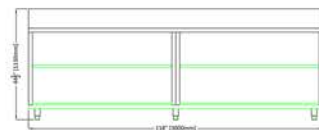

361-367 Beach Road, Burlingame, CA 94010  
Tel: 855.885.2400 | 650.342.2400 | Fax: 650.342.7400  
sales@oscartek.com | www.oscartek.com

